

W1AX6032FTO, W1AX6636FTO, W2AX6032FTO, W3AX6042FTO,
W3AX6636FTO, W4AX6032FTO, W4AX6636FTO

PARTS INCLUDED

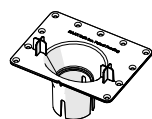

Installation
flange



Clamp

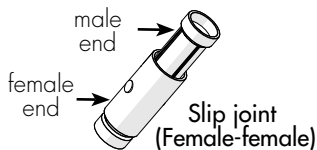

Slip joint
(Female-female)



Prevention
cap



Drain adapter
(use if required)



F² Drain video



STEPS BEFORE FLOOR FINISH

Step 1:

- With the help of the bathtub apron or the optional template, mark the center of the drainage line in relation with the desired position of the bathtub.
- Drill a hole (diameter between 4½" and 6") to the floor in the previously marked position.

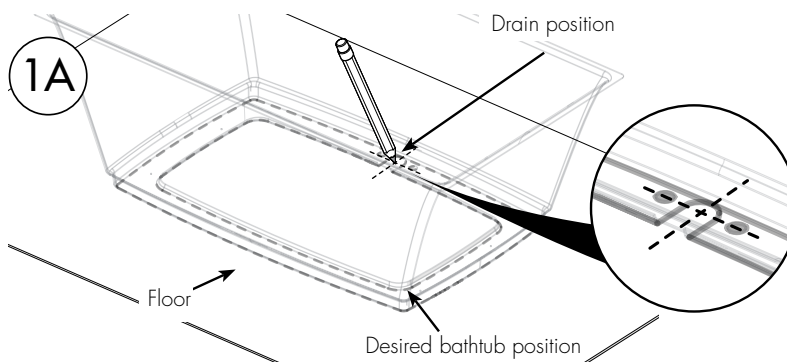

Step 2:

- Insert the female side of the slip joint until the shoulder of the mounting flange and tighten the clamp.
- Temporarily insert the slip joint's male part inside the F² drain and insert the prevention cap.
- Use aligning guide points to position the flange adjusted parallel to the adjacent wall. Fasten the flange in the floor.
- Finish connecting to the plumbing drain line under the floor. Paste as recommended by the plumbing code.

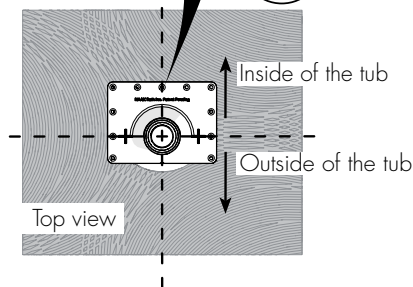
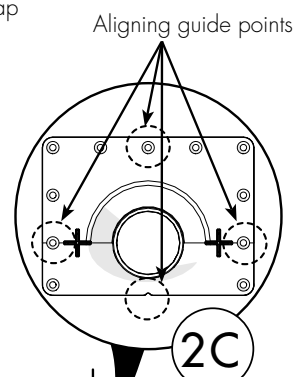
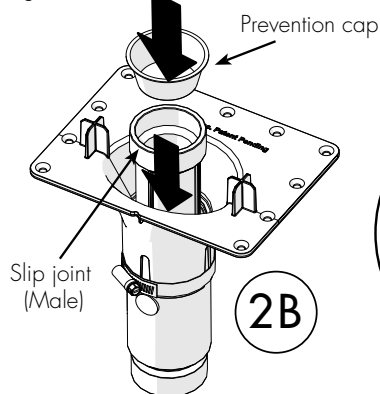
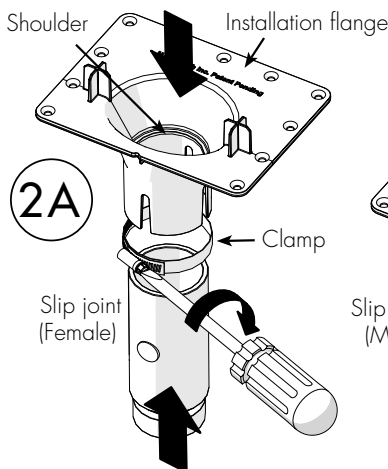

Step 3:

- Using the template or the bathtub skirt trace the inside rim of the skirt. Use this line as minimal limit for tile installation.

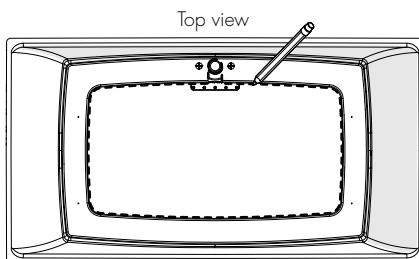

FINISHING STEPS

Step 1:

- A. After finishing the floor (tiles, etc.), place the bathtub on the side over cardboard and install the waste & overflow without fastening into the final position.
- B. Place the bathtub bottom up. Adjust the waste & overflow by aligning it with apron's predrilled holes shown (image 1B) so that the pierced holes on the apron are in line with the center line of drainage. If you have the optional template, use the provided measure to adjust the waste & overflow.

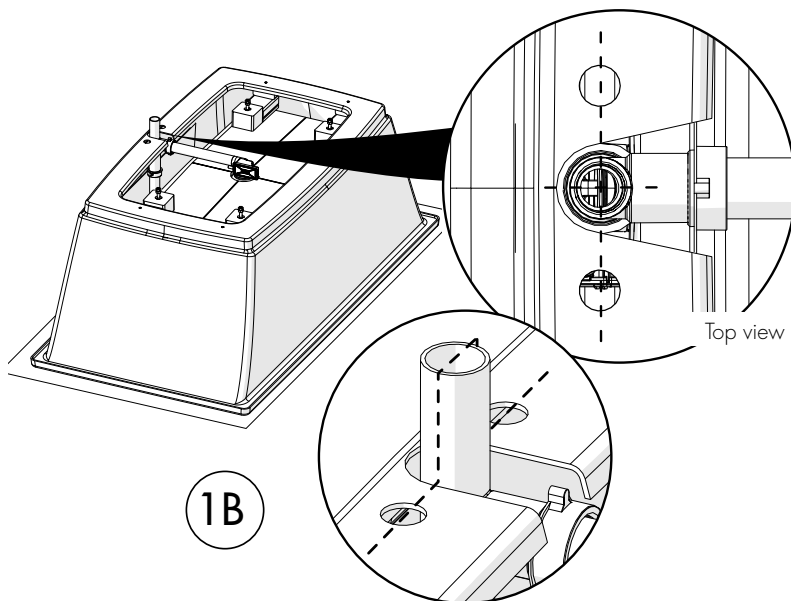

Step 2:

- A. Recover the male slip joint and remove the prevention cap. Install the male part of the slip joint with the drain line using the drain adapter if needed.
- B. Place the slip joint male end, **keeping a distance of no more than 3/4" between this piece and the apron.**
- C. Place the apron over the bathtub to level the legs with it by fastening or loosening them so that these last touches the ground once the installation is complete (see image 5B at the end of this guide). Use a straight object (for example with a 2x4) to ease the alignment.
- D. If the faucet must be installed on the deck of the bathtub, do the installation at this stage.

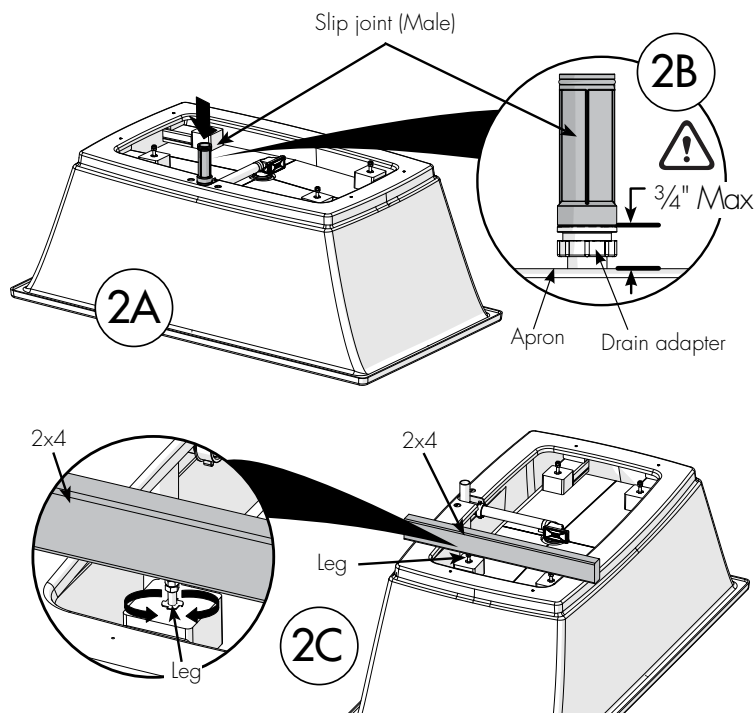

Step 3:

- A. Place the apron in the desired position, by aligning and inserting the alignment pins of the installation flange in the holes in the apron.
- B. Adjust position of the apron. Screw the apron to the floor as indicated in the bathtub installation guide. Drill 4 holes using a $\frac{3}{8}$ " drill bit in the indicated locations (Fig. 3B) and fasten to the ground. Apply a bead of silicone under the deck (optional).

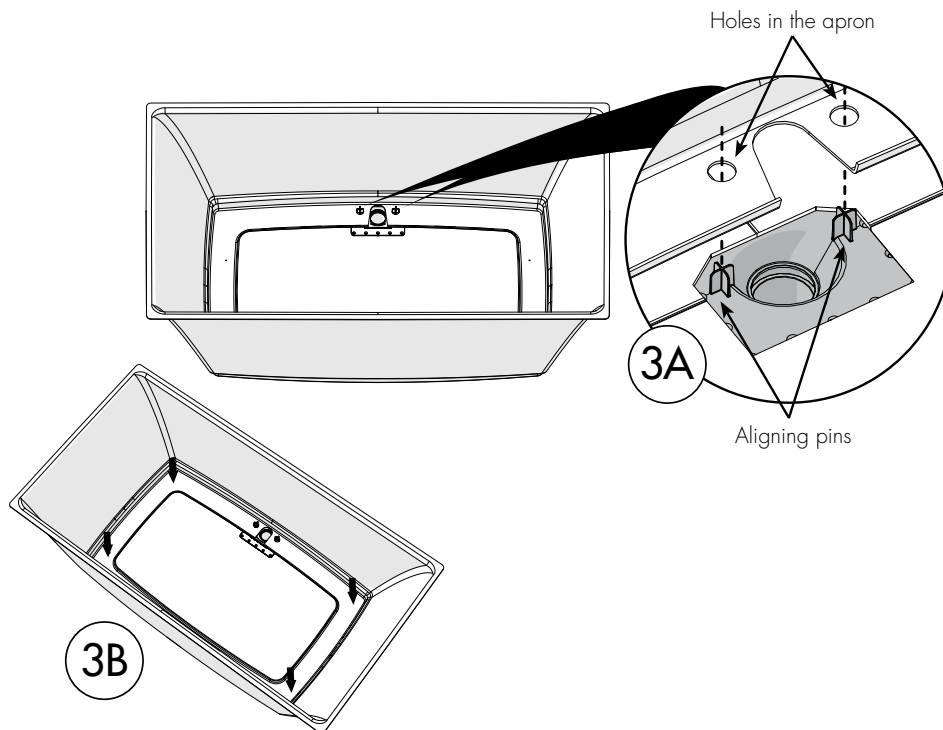

Step 4:

- A. Add two spacers (example 2x4) on the apron ends and insert the bathtub inside it (make sure the slip joint male part is inside the female part). In case the valves are installed on the bathtub, do the water connection fittings and test to prevent leakage. NOTE: Make sure there is an insulating strip between the deck and the apron.

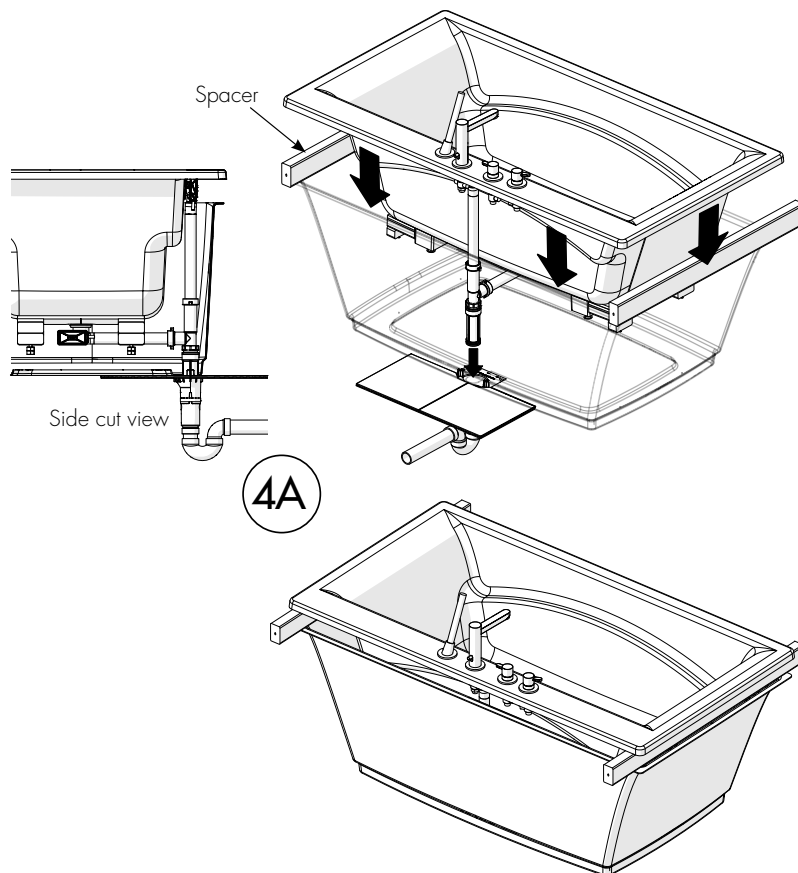

Step 5:

- A. Remove the spacers supports and lean the tub on the apron.
- B. Make sure all the legs are in contact with the ground, so that the bath is not supported by the apron.

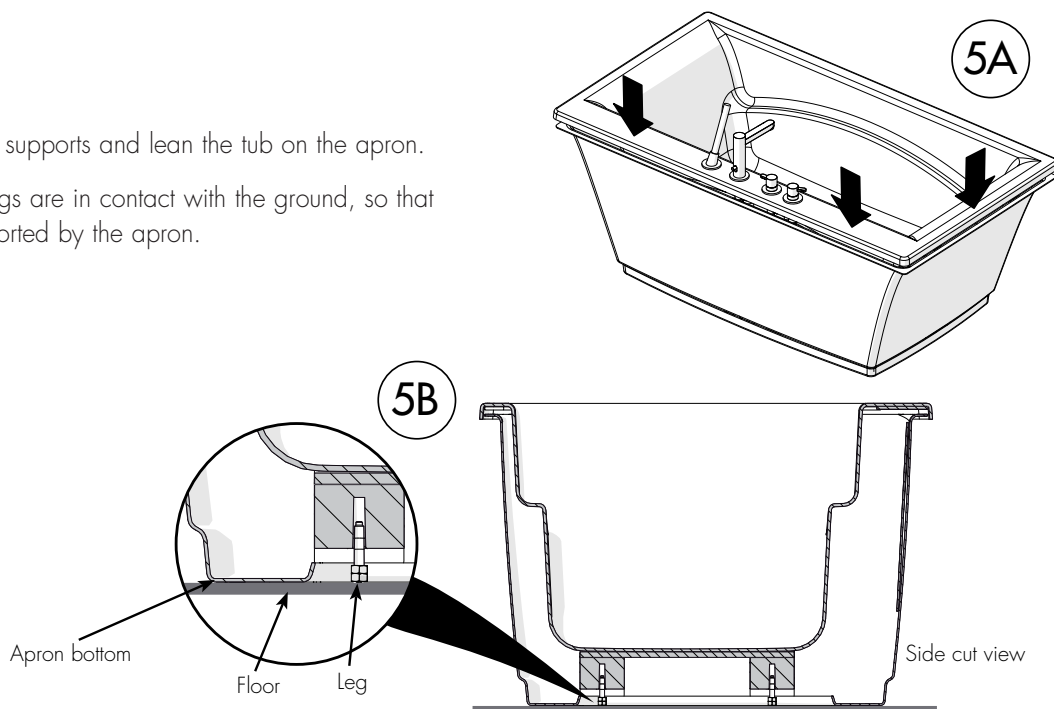

LIMITED WARRANTY

Aquatic Bath Inc. (hereafter "Aquatic") offers the following express limited warranty on each of its products. This warranty extends only to the original owner/end-user for personal household use. For commercial uses, additional limitations apply.

The warranty is only valid if the F2 drain is used with an Aquatic bath. Aquatic warrants F2 drain bracket to be free from defects in workmanship and materials under normal inside use and service for a period of three (3) years from the initial date of purchase by the owner/end-user, contractor or builder from an authorized dealer. Any product reported to the authorized dealer or to Aquatic as being defective within the warranty period will be repaired or replaced (with a product of equal value) at the option of Aquatic. This warranty extends to the original owner/end-user and is not transferable to a subsequent owner.

Neither the distributor, authorized Aquatic dealer nor or any other person has been authorized to make any affirmation, representation or warranty other than those contained in this warranty; any affirmation, representation or warranty other than those contained in this warranty shall not be enforceable against Aquatic or any other person.

Aquatic reserves the right to modify this warranty at any time, it being understood that such modification will not alter the warranty conditions applicable at the time of the sale of the products in question.