

*ALL ACCESSORIES OPTIONAL

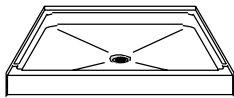

PERSPECTIVE VIEW - N.T.S.

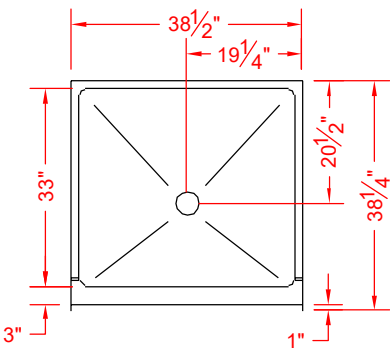

TOP VIEW - SCALE $\frac{3}{8}$ " = 1'-0"

- Features:
- Molded, one-piece gelcoat/fiberglass shower pan

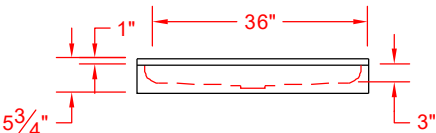

FRONT ELEVATION - SCALE: $\frac{3}{8}$ " = 1'-0"

<div>PRODUCT SPECIFICATIONS:</div> <div><div>-Single-piece shower pan shall be constructed of gelcoat/fiberglass</div><div>-Rough-In: Stud opening +1/4" -0" Nominal Dimensions.</div></div> <div>C.S.I. FORMAT SPECIFICATION TEXT AVAILABLE</div>		
<div>PRODUCT INFORMATION:</div> <div><div>-Colors: White as standard, others to match any major fixture manufacturer, also available with sprayable solid surface in many colors</div></div>	<div>OPTIONAL ACCESSORIES:</div> <div><div>INSTALLED BY OTHERS:</div><div>-No-caulk brass drain</div></div>	<div>CODES:</div> <div><div>Designed and manufactured in compliance with the following standards and codes:</div><div>-A.N.S.I. Z1241.2 Standards for plastic Bathtubs and Showers</div><div>-I.P.C. International Plumbing Code</div><div>-U.P.C. Uniform Plumbing Code</div></div>
		<div>NOTICE OF LIMITATION:</div>
<div><div> bestbath Intelligent Designs</div><div><div>We reserve the right to make revisions without notice in the design of fixtures or in packaging unless this right has specifically been waived at the time the order is accepted.</div></div></div> <div>Page 1 of 1</div>		