

Multi-Piece Shower & Tub Shower Installation Instructions

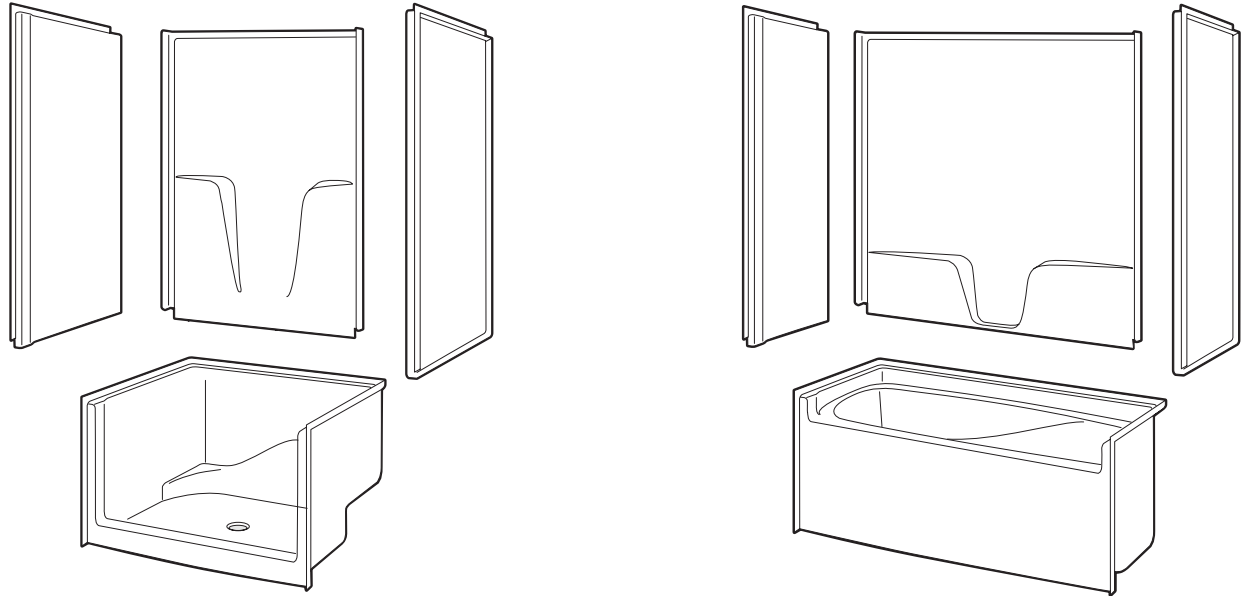

Materials and tools you may need for proper installation:

Materials:

- 1 tube of 100% silicone sealant
- Screws
 - Flat head wood screws for wood studs
 - Self-tapping sheet metal screws for metal studs
 - Flat head concrete screws for AcrylX floor flange
 - Counter sunk concrete screws for aluminium floor flange
- 2 large soft cloths
- 3 gallons of water (for testing slope to the drain)
- Drain kit (provided by others)

Tools:

- Caulking gun
- Hammer
- Drill
- 1/8 in. Drill bit
- Screwdriver
- 4 ft. level
- 2 ft. level
- Torpedo level
- Black Marker (to mark the threshold)

NOTICE: Please inspect the unit thoroughly before installation to make sure it has not been damaged during transportation. Under no circumstances should a damaged unit be installed. Neither the manufacturer nor the distributor will be responsible for the removal or reinstallation costs should a replacement be necessary due to installation of a damaged unit

STORAGE AND HANDLING

- Do not store unit(s) outdoors. Keep out of sunlight and exposure to weather.
- Most handling damage is the result of impact blows to the back side of the shower unit.
- Stress cracks can develop when shipping boards are removed before the unit is positioned for final installation in bathroom.
- Placing objects inside the tub or shower may cause scratches, abrasions, or nicks to the finished surface.
- Storing units outside right-side up may cause sunlight to discolor the AcrylX finish. The unit may become unstable and is easily knocked over by wind or by being bumped.
- The back side of the shower unit is not waterproof. Unit must be stored so that water will drain off of the unit and not accumulate in any one spot. Water can permeate the back laminates and soak the glass enclosed wood supports causing bulges in the finished surface.
- Never drag these units on any surface. Always transport the unit by hand using two people or a two-wheel dolly.
- Do not clean the shower finished surface with metal tools of any kind, including razors
- Wall board with water resistant finished material must be installed to complete the shower enclosure.
- Do not remove the medallion identification number. Doing so may affect the warranty. This number may be found above the drain, or on the left or right hand corner of the unit.

Multi-Piece Shower & Tub Shower Installation Instructions

Pre-Installation Planning

1. Make sure the alcove is of proper size. Framing alcove must reflect dimensions on the technical data sheet. Note the required opening in the floor to provide clearance for the drain trap and fitting connection. Finish the rough plumbing, but do not attach the unit to the studs at this stage.
2. Review the job print and the manufacturer's rough-in dimensions; verify all key dimensions against the actual job conditions. Make sure the framed in alcove is of proper size, square, and plumb. Check the floor for levelness.
3. If a fire-rated alcove is required, approved finish material must be in place prior to the unit's installation in order to meet fire safety requirements of the local building code and/or FHA/HUD Minimum Property Standards.
NOTE: Finished alcove must still have interior dimensions shown on technical data sheet to permit installation of unit.
4. To avoid obstruction, make sure that all supply lines and valve plumbing are not strapped to the studs and do not project into the alcove. Drain pipe must also not project above floor level prior to installation.
5. Make sure all plumbing is complete and to code.
6. To prevent scuffing while installing the unit, cover the entire bottom of the unit with a piece of cardboard or other protective material.
7. Fasten drain fitting to unit before install. [See manufacturer's instructions]

NOTE: For installation on gypsum concrete refer to gypsum concrete manufacturer for information about adhesion.

Standard Installation Instructions (for a foundation material bed install see page 6)

1. Ensure that the alcove is clean before continuing. Clear the area of dirt, trash, oil, grease, water, and other contaminants that may affect adhesion.
2. Check the dimensions of the alcove. Make sure the walls are square and plumb, and that floor is level. See figures 1a & 1b.
3. Disassemble wall set from base. Set walls aside. **CAUTION: While disassembling, secure walls to prevent damage.** Pre-install unit to ensure alcove is plumb, level, and square (Described in steps 4-8).
4. Lift and place the base into framing. Assure the waste pipe protrudes well into the drain fitting (for shower stall installation). Maintain the proper floor slope towards the drain. See figure 2.

Figure 1a

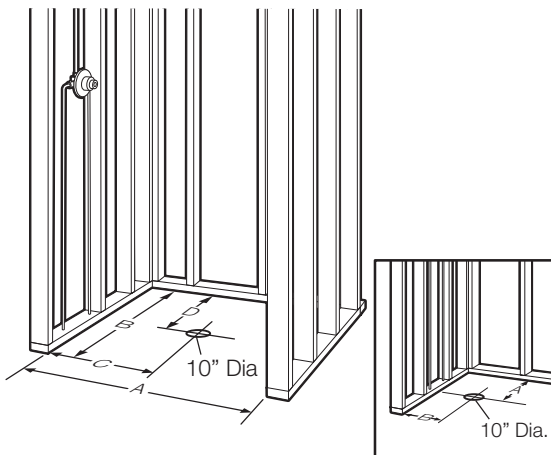
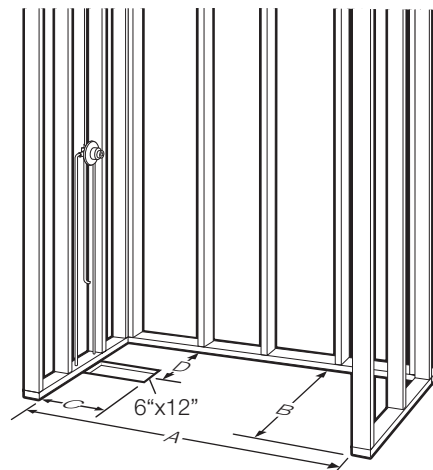

Figure 1b



5. Tap down on the base to level. Use wood wedges under the back of the unit to assist leveling. Mark studs on all sides. Draw a line on the floor across the front of the unit threshold. See figure 3.
6. Lift and place the back wall onto the base. See figure 4.
7. Level the back wall vertically and horizontally. Shim the back wall or base if necessary. See figure 5.

Multi-Piece Shower & Tub Shower Installation Instructions

Figure 2

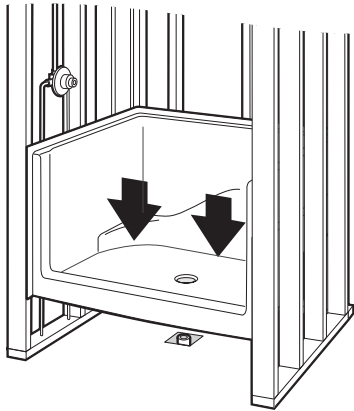
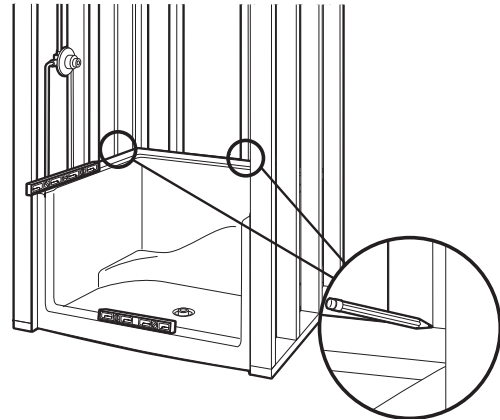

Figure 3



8. Dry fit remaining walls to ensure the unit fits properly inside the intended alcove, and pre-drill pilot holes every eight inches along the vertical flanges as well as at each stud along the horizontal flanges. See figure 6.
9. Remove the base and walls from the framing. See figure 7.

Figure 4

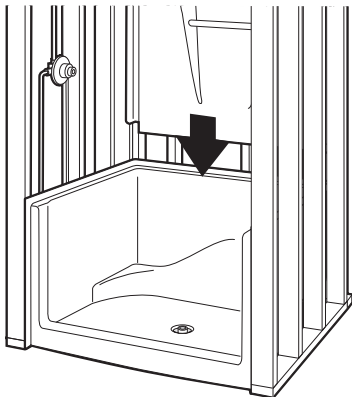
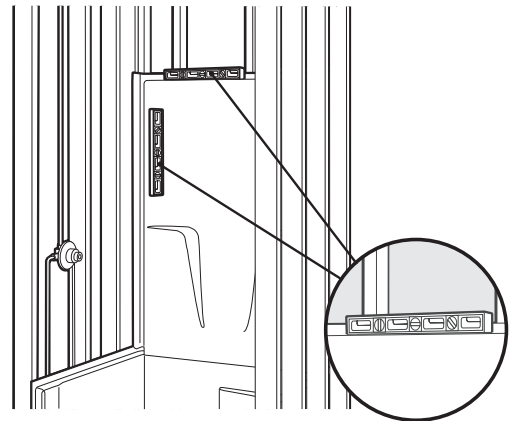

Figure 5



10. Install the drain assembly according to manufacturer's instructions. Tip: Remove the internal gasket. Set the unit into place and guide the drainpipe through the drain fitting using a hammer handle or similar object.

Figure 6

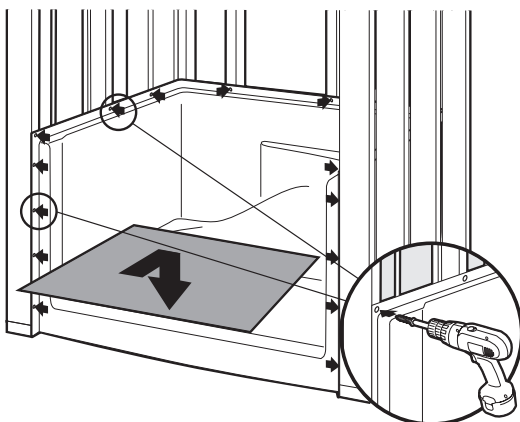
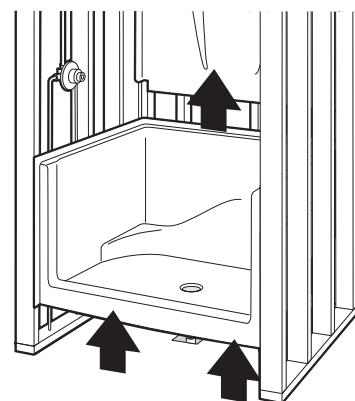

Figure 7



Multi-Piece Shower & Tub Shower Installation Instructions

11. Trial level the base outside of the framing pocket to determine the location of the wedges. On a flat surface, level the shower base across the finished flat sides of the base, and across the back edge of the base. Slide the wedges under the back of the unit until the shower base sits solid, plumb, and level in both directions. Draw a line along the front edge of the threshold. Then, mark the location of the wedges. Move the pan aside, and using your markings as reference, transfer the wedges to their location within the alcove.
12. Secure the wedges to the sub floor with fasteners or panel adhesive so they will not shift during installation of the unit.
13. Move the shower base into place. Position the unit at the open end of the framed pocket. Align the lower edge of the apron with the mark made in Step 5 and tilt the unit back into place. Carefully guide the drainpipe through the shower drain assembly. Lower the shower pan until it contacts the wedges already secured to the sub floor.
14. Repeat the leveling process from Step 11. If adjustments are necessary, remove the base from the alcove and move the wedges.
15. Fasten vertical nailing flange, if present, every eight inches. Fasten the horizontal nailing flanges at each stud.
16. Insert gasket around the drainpipe in the drain fitting and make final connections. Trim the drainpipe, if necessary.

NOTE: Manufacturer is not responsible for leaking drain connections.

17. Test unit for proper drainage by pouring 3-5 gallons of water into the shower base and monitoring. If the unit does not drain properly, the unit must be pulled back up to determine where the problem lies. Walls should be installed once the pan has been properly installed.

WARNING: Continuation of installation without water testing will void the warranty service if water does not drain completely following installation.

Figure 8

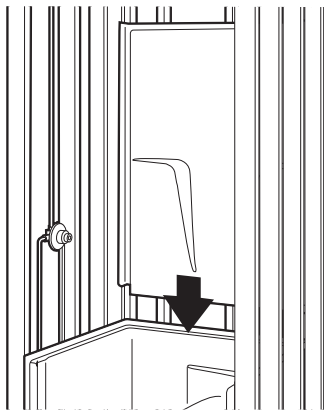
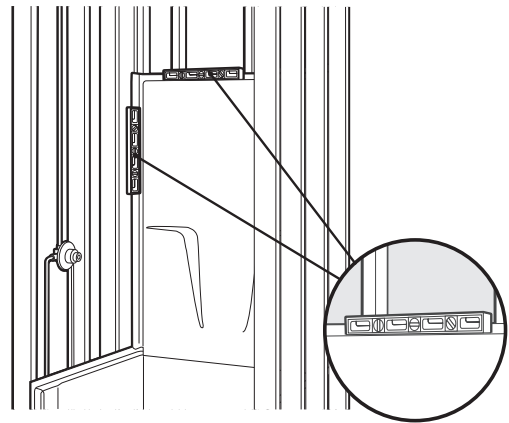

Figure 9



18. Lift back wall into position. See figure 8.
19. Check for level. See figure 9.
20. Fasten to framing at every stud along the horizontal nailing flange. See figure 10.
21. Silicone front edge, avoiding weep channel if present. Place the first side wall into position. See figure 11.
22. Check for level on unit. See figure 12.

Multi-Piece Shower & Tub Shower Installation Instructions

Figure 10

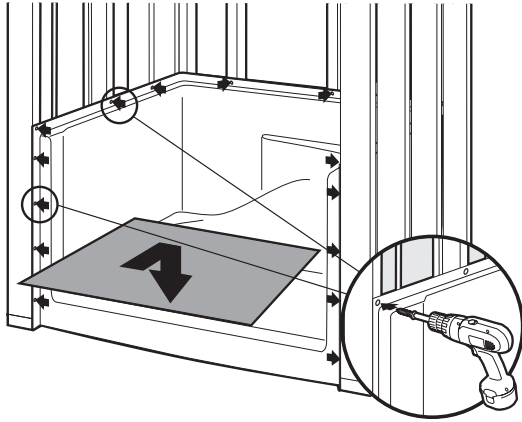
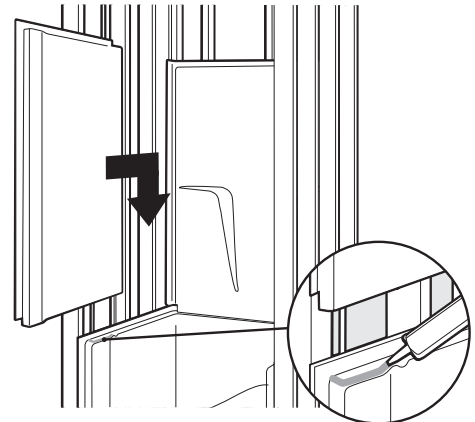

Figure 11



23. Fasten panel to framing at every stud and eight inches vertically through the mounting flanges. See figure 13.

Figure 12

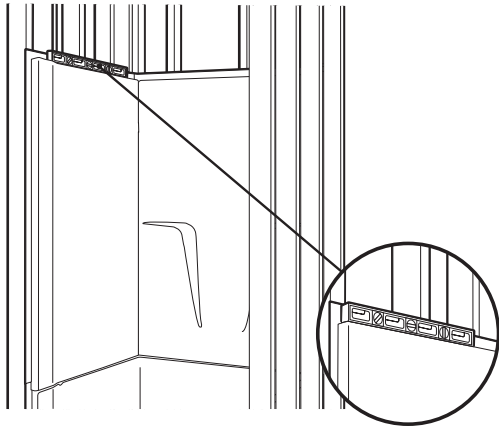
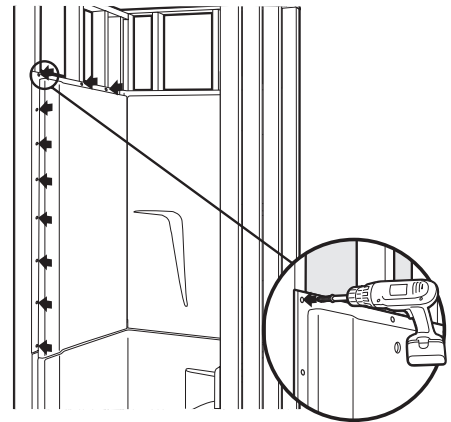

Figure 13



24. Silicone front edge, avoiding weep channel if present. Place the second side wall into position. Front reveal on the side wall and base should be flush. Check for level. See figure 14.

25. Fasten panel to framing at every stud and eight inches vertically through mounting flanges. See figure 15.

Figure 14

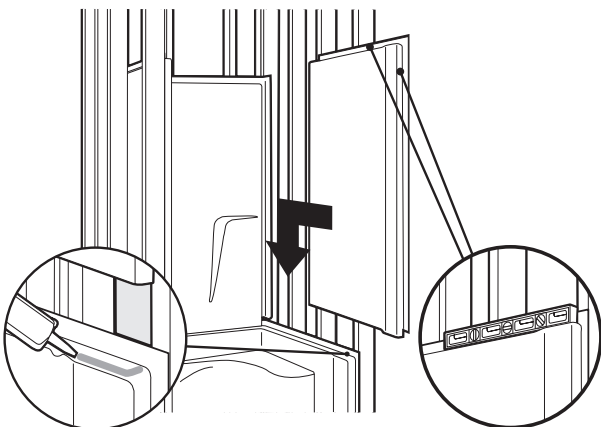
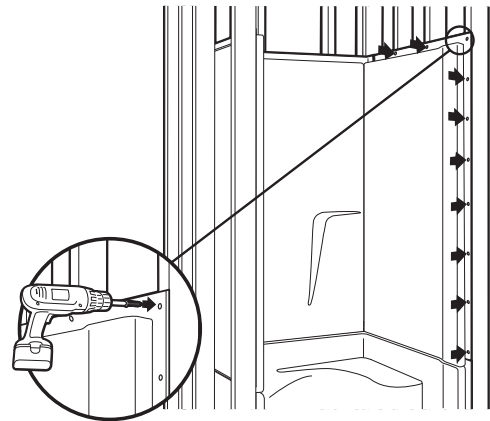

Figure 15



Multi-Piece Shower & Tub Shower Installation Instructions

26. Refer to manufacturer's technical data sheet for the measurements of the valves and shower accessories. Using a hole saw (fine tooth or abrasive grit cutting edge), make necessary openings for filler and valves, drilling from inside (smooth side) out. See figure 16.
27. Clean unit. Apply a strip of painter's masking tape along the inside edge of each side of the seam where silicone sealant will be applied. Apply silicone to the joints/seams and smooth over with finger or caulking tool. While the silicone is still wet, remove tape strips along joint edges. NOTE: Allow silicone to cure for 24 hours (normal cure time) before using bath or shower. Humidity affects the curing process and different geographical areas experience varying degrees of humidity. Refer to silicone manufacturer's instructions for additional information related to curing times. See figure 17.

Figure 16

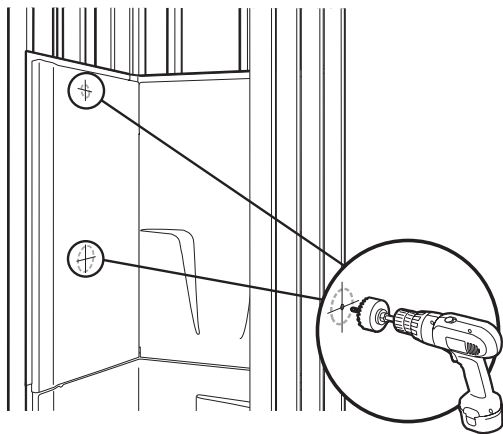
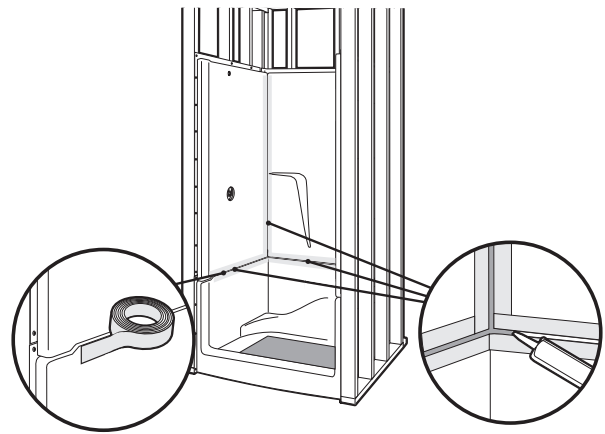

Figure 17



Installation Instructions for Gypsum Concrete or Other Foundation Material

After completion of the dry fitting steps described in the standard installation instructions (Steps 1-9) continue with installation of the ledger boards as described here.

1. Install drain fitting on unit base. Follow manufacturer installation instructions for the drain. Temporarily remove the internal gasket.
2. Refer to architectural drawings for the height of gypsum concrete or foundation material to be added after the unit has been installed. Use this height to determine the installation height of the unit. Mark this height on the studs with a marker.

NOTE: The bottom edge of the front apron (threshold) and any feet or supports on the bottom of the unit must contact the gypsum concrete or foundation material when it has fully cured.

3. Move the unit into place. Position the unit at the open end of the framed pocket. Align the lower edge of the apron with the mark made in Standard Installation Instructions - Step 5 and tilt the unit back into place. Carefully guide the drainpipe through the shower drain assembly. Lower the unit until it aligns with the marks that were made in Step 2.
4. Level the unit across the finished flat sides of the base and across the back edge of the base. Ensure that the unit is solid, plumb, and level in both directions.

Helpful Tip:

Temporarily remove the internal gasket. Set the unit into place and guide the drainpipe through the drain fitting using a hammer handle or similar object.

Multi-Piece Shower & Tub Shower Installation Instructions

5. Mount the unit to the studs using appropriate screws.

IMPORTANT: Do not step on the shower floor after it has been installed until foundation material has fully cured (Refer to material manufacturer for dry times).

6. Finish installation of the drainpipe into the shower drain assembly. If necessary, trim the pipe length. Insert gasket around the drainpipe in the drain fitting and make final connections. Walls should be installed once the unit base has been properly installed.
7. Test unit for proper drainage by pouring 3-5 gallons of water into the unit and monitoring. If the unit does not drain properly, the unit must be pulled back up to determine where the problem lies. Walls should be installed once the unit has been properly installed.

NOTE: Manufacturer is not responsible for leaking drain connections.

8. Continue with standard installation instructions from Step 18 for the installation of unit walls.
-

Following the appropriate installation procedures is imperative for this product. Not following these procedures could result in product failure, which will not be covered under the manufacturer's warranty.

Questions?

Please call 1.800.443.7269 for US Customers